

RoHS Compliant

| REV | LTR | DESCRIPTION | DATE | REVISER | SHEET |
|-----|-----|-------------|------------|------------|-------|
| A | | NEW RELEASE | 2019-05-08 | JIANG. REN | 1/2 |

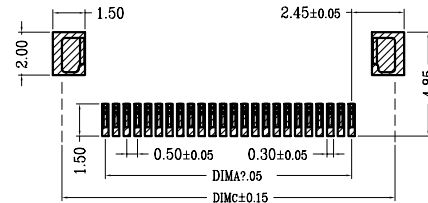

Suggested PCB Layout (Top View)
(Tolerance: ±0.05)

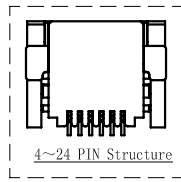
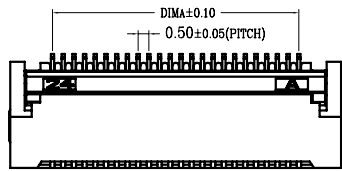
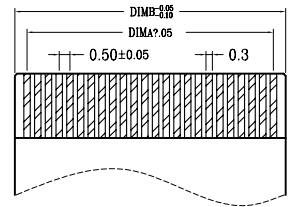
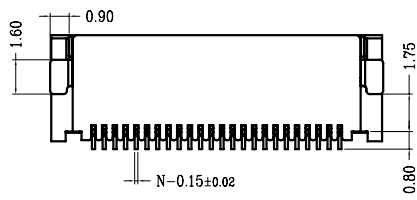
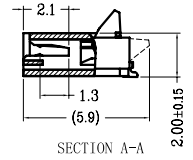
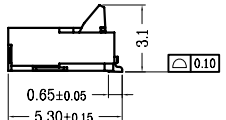
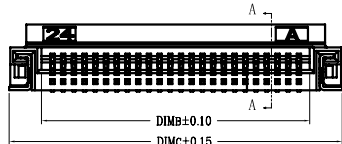

FFC Flexible Flat cable

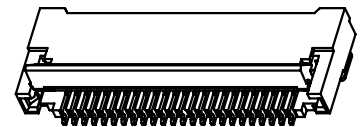

| CKT | DIMA | DIMB | DIMC | CKT | DIMA | DIMB | DIMC |
|-----|-------|-------|-------|-----|-------|-------|-------|
| 4 | 1.50 | 2.52 | 5.54 | 33 | 16.00 | 17.02 | 20.04 |
| 5 | 2.00 | 3.02 | 6.04 | 34 | 16.50 | 17.52 | 20.54 |
| 6 | 2.50 | 3.52 | 6.54 | 35 | 17.00 | 18.02 | 21.04 |
| 7 | 3.00 | 4.02 | 7.04 | 36 | 17.50 | 18.52 | 21.54 |
| 8 | 3.50 | 4.52 | 7.54 | 37 | 18.00 | 19.02 | 22.04 |
| 9 | 4.00 | 5.02 | 8.04 | 38 | 18.50 | 19.52 | 22.54 |
| 10 | 4.50 | 5.52 | 8.54 | 39 | 19.00 | 20.02 | 23.04 |
| 11 | 5.00 | 6.02 | 9.04 | 40 | 19.50 | 20.52 | 23.54 |
| 12 | 5.50 | 6.52 | 9.54 | 41 | 20.00 | 21.02 | 24.04 |
| 13 | 6.00 | 7.02 | 10.04 | 42 | 20.50 | 21.52 | 24.54 |
| 14 | 6.50 | 7.52 | 10.54 | 43 | 21.00 | 22.02 | 25.04 |
| 15 | 7.00 | 8.02 | 11.04 | 44 | 21.50 | 22.52 | 25.54 |
| 16 | 7.50 | 8.52 | 11.54 | 45 | 22.00 | 23.02 | 26.04 |
| 17 | 8.00 | 9.02 | 12.04 | 46 | 22.50 | 23.52 | 26.54 |
| 18 | 8.50 | 9.52 | 12.54 | 47 | 23.00 | 24.02 | 27.04 |
| 19 | 9.00 | 10.02 | 13.04 | 48 | 23.50 | 24.52 | 27.54 |
| 20 | 9.50 | 10.52 | 13.54 | 49 | 24.00 | 25.02 | 28.04 |
| 21 | 10.00 | 11.02 | 14.04 | 50 | 24.50 | 25.52 | 28.54 |
| 22 | 10.50 | 11.52 | 14.54 | 51 | 25.00 | 26.02 | 29.04 |
| 23 | 11.00 | 12.02 | 15.04 | 52 | 25.50 | 26.52 | 29.54 |
| 24 | 11.50 | 12.52 | 15.54 | 53 | 26.00 | 27.02 | 30.04 |
| 25 | 12.00 | 13.02 | 16.04 | 54 | 26.50 | 27.52 | 30.54 |
| 26 | 12.50 | 13.52 | 16.54 | 55 | 27.00 | 28.02 | 31.04 |
| 27 | 13.00 | 14.02 | 17.04 | 56 | 27.50 | 28.52 | 31.54 |
| 28 | 13.50 | 14.52 | 17.54 | 57 | 28.00 | 29.02 | 32.04 |
| 29 | 14.00 | 15.02 | 18.04 | 58 | 28.50 | 29.52 | 32.54 |
| 30 | 14.50 | 15.52 | 18.54 | 59 | 29.00 | 30.02 | 33.04 |
| 31 | 15.00 | 16.02 | 19.04 | 60 | 29.50 | 30.52 | 33.54 |
| 32 | 15.50 | 16.52 | 19.54 | | | | |

NOTES:

1. MATERIALS:

HOUSING:LCP(UL 94V-0)NATURAL COLOR

ACTUATOR:LCP(UL 94V-0)BLACK

TERMINAL:PHOSPHOR BRONZE

FITTING NAIL:PHOSPHOR BRONZE

2. PLATING:

TERMINAL:NICKEL PLATING OVERALL AND TIN PLATING

FITTING NAIL:NICKEL PLATING OVERALL AND TIN PLATING

3. ORDER INFORMATION

FrelTec GmbH

| | | | | | |
|------------|-------------|--|---------------------------|----------------------------------|-------------|
| TOLERANCE | ANGLE | TITLE: 0.5MM Pitch Flat cable connector H=2.0 | | | |
| .XXX ±0.10 | .XXX° ±1.0° | PART NO. : 2C2FPT05yxxNUWHB02WF | | DRAWING NO. : ABKF-18Sxx-D000 | |
| .XX ±0.15 | .XX° ±2.0° | MOLD: XXX | SCALE: 1 : 1 | UNIT: mm | SIZE: A4 |
| .X ±0.25 | .X° ±3.0° | REV. A | | | |
| PROJECTION | | APPROVED BY SW. MO | CHECKED BY LIANG. ZHUO | DRAWING BY W. D | |

