

RoHS Compliant

REV	LTR	DISCRIPTION	DATE	REVISER	SHEET
A	/	NEW RELEASE	2016.06.21	Jiang REN	1/1

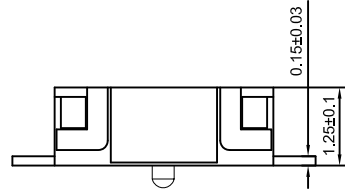

- Specifications:
- 1.Current Rating: 50mA 12V DC
  - 2.Contact Resistance: ≤100mΩ
  - 3.Operating Force: 180±50gf
  - 4.Travel: 0.2±0.1mm
  - 5.Insulation Resistance: ≥100MΩ
  - 6.Withstand Voltage: AC 250V 50HZ 1Min.
  - 7.Durability: 100,000 Cycles

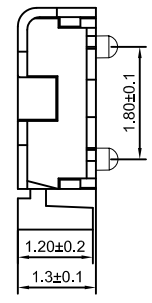
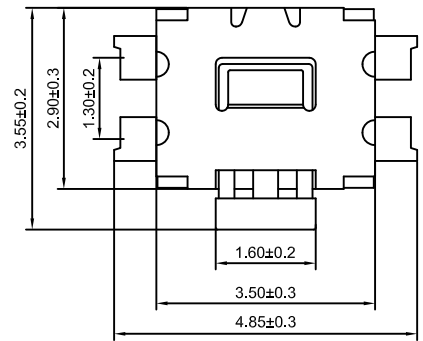
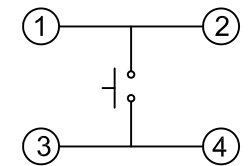
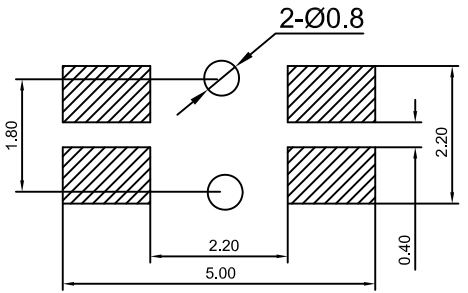

SCHEMATIC

PCB LAYOUT

# FrelTec GmbH

6	Terminals	Bronze	1	Silver Plating
5	Base	LCP	1	Temperature Resistance (Black)
4	Dustproof Film	Polyimide Film	1	Temperature Resistance (Yellow)
3	Spring	Stainless Steel	2	Silver Plating
2	Cover	Stainless Steel	1	/
1	Button	PPA	1	Temperature Resistance (Black)
No.	Description	Materials	Q'TY	Remark

TOLERANCE	ANGLE	TITLE: Push Switch 3.5x3.55mm			
.XXX ±0.10	.XXX° ±1.0°	PART NO.: 4S0PS39BRSPBLL0312		DRAWING NO.: TS-1116C	
.XX ±0.15	.XX° ±2.0°	MOLD: XXX	SCALE: 1:1	UNIT: mm	SIZE: A4
.X ±0.25	.X° ±3.0°	APPROVED BY: Vegas LIU		CHECKED BY: Liang ZHUO	REV. A
PROJECTION		DRAWING BY: Jiang REN			

